

## Reduced Tee Female

**Manufacturing standards:** DVGW round tubes manufactured according to DIN-1988/2463 EN 10312 Tubes with DVGW TS 225 approval correspond to the requirements of DVGW worksheet W 541

**Certificates:** Standard supply in lengths of 6 m. We provide product certificates if required, according to the following standard: EN 10204/3.1.B or DIN 50049.

**Grades:** Austenitic grades types 304-L, 316-L

**Dimensions:** Manufactured in diameters from 15 mm to 108 mm. Wall thicknesses from 1 to 2 mm

**Applications:** DVGW W 541 tubes are used in the transport of drinking and chlorinated water up to 2 mg/l in water with AISI-316 L pipes, AISI-304 L quality is used in compressed air installations.

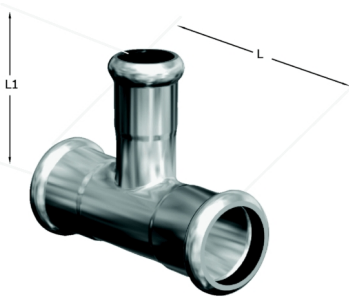

### Technical information

DN	Dimensiones			Art.
	Tubo Ø	L	L1	
15-12	18-15-18	68	41	1204
20-12	22-15-22	74	43	1206
20-15	22-18-22	74	43	1207
25-12	28-15-28	84	46	1209
25-15	28-18-28	84	46	1210
25-20	28-22-28	84	47	1211
32-12	35-15-35	100	49	1212
32-15	35-18-35	100	49	1213
32-20	35-22-35	100	50	1214
32-25	35-28-35	100	53	1215
40-12	42-15-42	114	53	1216
40-15	42-18-42	114	53	1217
40-20	42-22-42	114	54	1218
40-25	42-28-42	114	57	1219
40-32	42-35-42	114	61	1220
50-12	54-15-54	138	59	1221

50-15	54-18-54	138	59	1222
50-20	54-22-54	138	60	1223
50-25	54-28-54	138	63	1224
50-32	54-35-54	138	67	1225
50-40	54-42-54	138	71	1226
65-20	76,1-22-76,1	230	77	1229
65-25	76,1-28-76,1	230	79	1230
65-32	76,1-35-76,1	230	81	1231
65-40	76,1-42-76,1	230	81	1232
65-50	76,1-54-76,1	230	87	1233
80-20	88,9-22-88,9	260	85	1236
80-25	88,9-28-88,9	260	87	1237
80-32	88,9-35-88,9	260	90	1238
80-40	88,9-42-88,9	260	92	1239
80-50	88,9-54-88,9	260	93	1240
80-65	88,9-76,1-88,9	260	114	1241
100-20	108-22-108	310	103	1244
100-25	108-28-108	310	105	1245
100-32	108-35-108	310	108	1246
100-40	108-42-108	310	110	1247
100-50	108-54-108	310	113	1248
100-65	108-76,1-108	310	124	1249
100-80	108-88,9-108	310	135	1250