

## 1-Piece Ball Valve-Full Bore (Art. 110)

### Characteristics:

FULL BORE BALL VALVE 1 PIECE

ASSEMBLY BETWEEN PN FLANGES - 16

BALL BODY AND SHAFT: STAINLESS STEEL. AISI 316

GASKETS: PTFE

TEMP. -30°C +180°C

MANUAL CONTROL BY LEVER

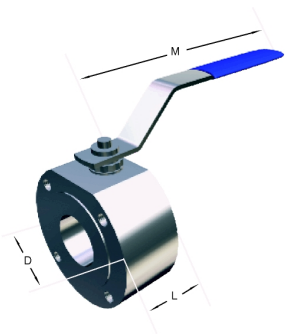

### Technical information

Medida	D	D1	C	H	L	M	Rm	Peso
1/2"	90	88	65	90	32	130	12	1.32
3/4"	100	98	75	90	42	180	12	2.13
1"	110	108	85	90	45	180	12	2.65
1 1/4"	130	128	100	110	54	270	16	4.64
1 1/2"	140	138	110	110	65	280	16	6.35
2"	150	148	125	125	72	280	16	7.45
2 1/2"	170	175	145	150	98	360	16	14
3"	190	188	160	160	118	360	16	21.2
4"	220	210	180	180	140	470	16	28.85