

## Mamelon de tuyau de soudage, mâle (Fig. 149)

**Thread type:** The accessories are threaded with dimensions compatible with the ISO 7/1 standard.

**Finishes:** Polished and matte

**Quality:** They are made of bar, tube or micro fusion of AISI-316 stainless steel.

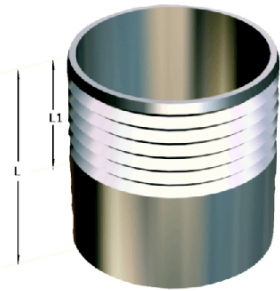

### Information technique

Ø Nominal en pulgadas	Pulida			Mate			Peso kgs
	D	L	L1	L	L1		
1/8"							
1/4"	13.5	24	12	30	12	0.01	
3/8"	17.2	25	13	30	13	0.024	
1/2"	21.3	27	14	35	14	0.036	
3/4"	26.9	29	15	40	15	0.055	
1"	33.7	32	17	40	17	0.08	
1 1/4"	42.4	35	19	50	19	0.139	
1 1/2"	48.3	38	21	50	21	0.167	
2"	60.3	42	23	50	23	0.214	
2 1/2"	76.1	46	25	60	25	0.464	
3"	88.9	50	27	70	27	0.647	
4"	114.3	55	30	80	30	1.05	