

CT 205 three-exit square

SQUAD of THREE EXITS

Material: Cast stainless steel.

Quality: AISI 316.

Finish: Gloss (see satin finish).

Description: Three-output square connector with threads at the ends that ensure a perfect fit for definitive fixation using adhesive (LOCTITE 638 recommended).

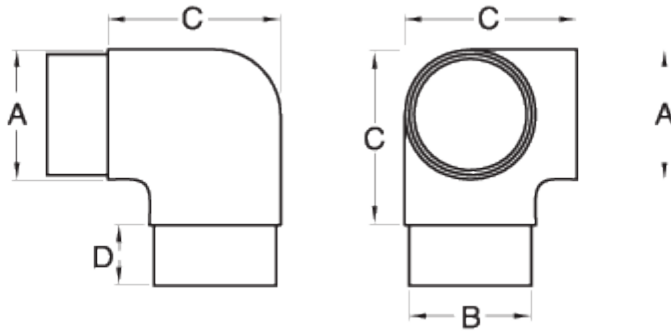

Technical information

Código	Descripción	A	B	C
1803184CT20543	CONECTOR ESCUADRA A-316 REF. CT-205 43	43	40	55
1803184CT20550	CONECTOR ESCUADRA 316 CT-205 50,8	50.8	47.8	60