

Eccentric Reducer, Schedule ASTM

Manufacturing Standards: welding components are manufactured according to ASTM-403WP-S (ANSI B 16.9) standards.

Grade: Austenitic series 304 - L, 316-L

Finishes: Standard finish L / C

Dimensions: Diameters from 1 / 4 " to 24".

Certificates: Product certificates provide if required, according to the following standard: EN 10204/3.1.B or DIN 50049.

Tolerances: Allowable differences in diameter and eccentricity + - 1.0% and thickness + - 12.55%

Applications: ASTM tubes are used in industrial environments of extreme temperatures and corrosive media. Also used in equipment: heaters, heat exchangers and reactors, and in the conduction of acid from the petrochemical, oil and food processing industries.

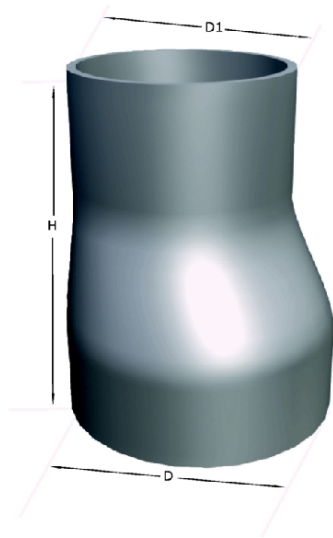

Technical information

DN Pulgadas	dn	Dimensiones							Calidades AISI	
	Pulgadas	Schedule	Ø D	Ø D1	Espesor e	Espesor e1	H	Peso	304-L	316-L
3/4"	1/2"	10S	26.7	21.3	2.11	2.11	39.3	0.1	*	*
3/4"	1/2"	40S	26.7	21.3	2.87	2.77	39.3	0.14	*	*
1"	1/2"	10S	33.4	21.3	2.77	2.11	50.8	0.12	*	*
1"	1/2"	40S	33.4	21.3	3.38	2.77	50.8	0.15	*	*
1"	3/4"	10S	33.4	26.7	2.77	2.11	50.8	0.13	*	*
1"	3/4"	40S	33.4	26.7	3.38	2.87	50.8	0.16	*	*

1 1/4"	1"	10S	42.2	33.4	2.77	2.77	50.8	0.18	*	*
1 1/4"	1"	40S	42.2	33.4	3.56	3.38	50.8	0.22	*	*
1 1/2"	3/4"	10S	48.3	26.7	2.77	2.11	63.5	0.2	*	*
1 1/2"	3/4"	40S	48.3	26.7	3.68	2.87	63.5	0.26	*	*
1 1/2"	1"	10S	48.3	33.4	2.77	2.77	63.5	0.2	*	*
1 1/2"	1"	40S	48.3	33.4	3.68	3.38	63.5	0.26	*	*
1 1/2"	1 1/4"	10S	48.3	42.2	2.77	2.77	63.5	0.21	*	*
1 1/2"	1 1/4"	40S	48.3	42.2	3.68	3.56	63.5	0.28	*	*
2"	1"	10S	60.3	33.4	2.77	2.77	76.2	0.28	*	*
2"	1"	40S	60.3	33.4	3.91	3.38	76.2	0.4	*	*
2"	1 1/4"	10S	60.3	42.2	2.77	2.77	76.2	0.3	*	*
2"	1 1/2"	10S	60.3	48.3	2.77	2.77	76.2	0.31	*	*
2"	1 1/2"	40S	60.3	48.3	3.91	3.68	76.2	0.45	*	*
2 1/2"	2"	10S	73	60.3	3.05	2.77	88.9	0.47	*	*
2 1/2"	2"	40S	73	60.3	5.16	3.91	88.9	0.8	*	*
3"	1 1/2"	10S	88.9	48.3	3.05	2.77	88.9	0.51	*	*
3"	1 1/2"	40S	88.9	48.3	5.49	3.68	88.9	0.94	*	*
3"	2"	10S	88.9	60.3	3.05	2.77	88.9	0.55	*	*
3"	2"	40S	88.9	60.3	5.49	3.91	88.9	1	*	*
3"	2 1/2"	10S	88.9	73	3.05	2.77	88.9	0.59	*	*
3"	2 1/2"	40S	88.9	73	5.49	5.16	88.9	1.08	*	*
4"	2"	10S	114.3	60.3	3.05	2.77	101.6	0.78	*	*
4"	2"	40S	114.3	60.3	6.02	3.91	101.6	1.57	*	*
4"	2 1/2"	10S	114.3	73	3.05	3.05	101.6	0.83	*	*
4"	2 1/2"	40S	114.3	73	6.02	5.16	101.6	1.66	*	*
4"	3"	10S	114.3	88.9	3.05	3.05	101.6	0.87	*	*
4"	3"	40S	114.3	88.9	6.02	5.49	101.6	1.74	*	*
5"	3"	10S	141.3	88.9	3.4	3.05	127	1.45	*	*
5"	3"	40S	141.3	88.9	6.55	5.49	127	2.85	*	*
5"	4"	10S	141.3	114.3	3.4	3.05	127	1.49	*	*
5"	4"	40S	141.3	114.3	6.55	6.02	127	2.98	*	*
6"	3"	10S	168.3	88.9	3.4	3.05	139.7	1.82	*	*
6"	3"	40S	168.3	88.9	7.11	5.49	139.7	3.98	*	*
6"	4"	10S	168.3	114.3	3.4	3.05	139.7	1.95	*	*
6"	4"	40S	168.3	114.3	7.11	6.02	139.7	4.08	*	*
6"	5"	10S	168.3	141.3	3.4	3.4	139.7	2	*	*
6"	5"	40S	168.3	141.3	7.11	6.55	139.7	4.15	*	*
8"	4"	10S	219.1	114.3	3.76	3.05	152.4	3.02	*	*
8"	4"	40S	219.1	114.3	8.18	6.02	152.4	6.55	*	*
8"	5"	10S	219.1	141.3	3.76	3.05	152.4	3.08	*	*

8"	5"	40S	219.1	141.3	8.18	6.02	152.4	6.7	*	*
8"	6"	10S	219.1	168.3	3.76	3.4	152.4	3.19	*	*
8"	6"	40S	219.1	168.3	8.18	7.11	152.4	6.94	*	*
10"	6"	10S	273.1	168.3	4.19	3.4	177.8	5	*	*
10"	6"	40S	273.1	168.3	9.27	7.11	177.8	11.12	*	*
10"	8"	10S	273.1	219.1	4.19	3.76	177.8	5.25	*	*
10"	8"	40S	273.1	219.1	9.27	8.18	177.8	11.56	*	*
12"	6"	10S	323.9	168.3	4.57	3.4	203.2	7.45	*	*
12"	6"	40S	323.9	168.3	9.53	7.11	203.2	11.12	*	*
12"	8"	10S	323.9	219.1	4.57	3.76	203.2	7.67	*	*
12"	8"	40S	323.9	219.1	9.53	8.18	203.2	15.98	*	*
12"	10"	10S	323.9	273.1	4.57	4.19	203.2	7.98	*	*
12"	10"	40S	323.9	273.1	9.53	9.27	203.2	16.63	*	*
14"	10"	10S	355.6	273.1	4.78	4.19	330.2	14.41	*	*
14"	12"	10S	355.6	323.9	4.78	4.19	330.2	15.29	*	*
16"	10"	10S	406.4	273.1	4.78	4.19	355.6	17.72	*	*
16"	12"	10S	406.4	323.9	4.78	4.19	355.6	18.35	*	*
6"	3"	10S	168.3	88.9	3.4	3.05	139.7	1.82	x	x
6"	3"	40S	168.3	88.9	7.11	5.49	139.7	3.98	*	*
6"	3"	80S	168.3	88.9	10.97	7.62	139.7	5.51	*	*
6"	4"	10S	168.3	114.3	3.4	3.05	139.7	1.95	x	x
6"	4"	40S	168.3	114.3	7.11	6.02	139.7	4.08	*	*
6"	4"	80S	168.3	114.3	10.97	8.56	139.7	5.96	*	*
6"	5"	10S	168.3	141.3	3.4	3.4	139.7	2.05	x	x
6"	5"	40S	168.3	141.3	7.11	6.55	139.7	4.18	*	*
8"	4"	10S	219.1	114.3	3.76	3.05	152.4	3.02	x	x
8"	4"	40S	219.1	114.3	8.18	6.02	152.4	6.55	*	*
8"	5"	10S	219.1	141.3	3.76	3.4	152.4	3.08	*	*
8"	5"	40S	219.1	141.3	8.18	6.55	152.4	6.7	*	*
8"	6"	10S	219.1	168.3	3.76	3.4	152.4	3.19	x	x
8"	6"	40S	219.1	168.3	8.18	7.11	152.4	6.94	*	*
10"	6"	10S	273.1	168.3	4.19	3.4	177.8	5	x	x
10"	6"	40S	273.1	168.3	9.27	7.11	177.8	11.12	*	*
10"	8"	10S	273.1	219.1	4.19	3.76	177.8	5.25	x	x
10"	8"	40S	273.1	219.1	9.27	8.18	177.8	11.56	*	*
12"	6"	10S	323.9	168.3	4.57	3.4	203.2	6.58	*	*
12"	6"	40S	323.9	168.3	9.53	7.11	203.2	12.8	*	*
12"	8"	10S	323.9	219.1	4.57	3.76	203.2	7.67	*	*
12"	8"	40S	323.9	219.1	9.53	8.18	203.2	15.98	*	*
12"	10"	10S	323.9	273.1	4.57	4.19	203.2	7.98	*	*

12"	10"	40S	323.9	273.1	9.53	9.27	203.2	16.63	*	*
14"	8"	10S	355.6	219.1	4.78	3.76	330.2	13.88	*	*
14"	10"	10S	355.6	273.1	4.78	4.19	330.2	14.41	*	*
14"	12"	10S	355.6	323.9	4.78	4.57	330.2	15.29	*	*
16"	8"	10S	406.4	219.1	4.78	3.76	330.2	16.5	*	*
16"	10"	10S	406.4	273.1	4.78	4.19	355.6	17.72	*	*
16"	12"	10S	406.4	323.9	4.78	4.57	355.6	18.35	*	*
16"	14"	10S	406.4	355.6	4.78	4.78	355.6	18.9	*	*