

## Stub Ends, Schedule ASTM

**Manufacturing Standards:** Welding components are manufactured according to ASTM-403WP-S (ANSI B 16.9) standards.

**Grade:** Austenitic series 304 - L, 316-L

**Finish:** Standard finish L / C

**Dimensions:** Diameters from 1 / 4 " to 24".

**Certificates:** Product certificates provide if required, according to the following standard: EN 10204/3.1.B or DIN 50049.

**Tolerances:** Allowable differences in diameter and eccentricity + - 1.0% and thickness + - 12.55%

**Applications:** ASTM tubes are used in industrial environments with extreme temperatures and exposure to corrosive agents. Also used in equipment: heaters, heat exchangers and reactors, such as in the conduction of acid in the petrochemical, oil and food processing industries.

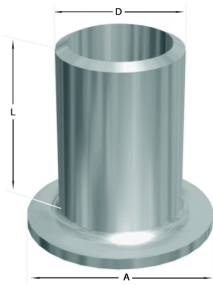

### Technical information

DN Pulgadas	Dimensiones							Calidades AISI	
	Schedule	Ø D	Espesor	A	L	R	Peso	304-L	316-L
1/2"	10	21.34	2.11	34.9	50.8	3.18	0.07	x	x
1/2"	40	21.34	2.77	34.9	50.8	3.18	0.09	*	*
3/4"	10	26.67	2.11	34.9	50.8	3.18	0.1	x	x
3/4"	40	26.67	2.87	34.9	50.8	3.18	0.12	*	*
1"	10	33.4	2.77	34.9	50.8	3.18	0.16	x	x
1"	40	33.4	3.38	34.9	50.8	3.18	0.17	*	*
1 1/4"	10	42.16	2.77	34.9	50.8	4.76	0.22	x	x
1 1/4"	40	42.16	3.56	34.9	50.8	4.76	0.25	*	*
1 1/2"	10	48.26	2.77	34.9	50.8	6.35	0.25	x	x
1 1/2"	40	48.26	3.68	34.9	50.8	6.35	0.31	*	*

2"	10	60.32	2.77	92.1	63.5	7.94	0.43	x	x
2"	40	60.32	3.31	92.1	63.5	7.94	0.61	*	*
2 1/2"	10	73.02	3.05	104.8	63.5	7.94	0.57	x	x
2 1/2"	40	73.02	5.13	104.8	63.5	7.94	0.8	*	*
3"	10	88.9	3.05	127	63.5	9.53	0.73	x	x
3"	40	88.9	5.49	127	63.5	9.53	1.13	*	*
4"	10	114.3	3.05	157.2	76.2	11.11	1.09	x	x
4"	40	114.3	6.02	157.2	76.2	11.11	1.67	*	*
5"	10	141.3	3.4	185.7	76.2	11.11	1.47	x	x
5"	40	141.3	6.55	185.7	76.2	11.11	2.25	*	*
6"	10	168.27	3.4	215.9	88.9	12.7	2.15	x	x
6"	40	168.27	7.11	215.9	88.9	12.7	3.57	*	*
8"	10	219.07	3.76	269.9	101.6	12.7	3.22	x	x
8"	40	219.07	8.18	269.9	101.6	12.7	6.07	*	*
10"	10	273.1	4.19	323.9	127	12.7	5.13	x	x
10"	40	273.1	9.27	323.9	127	12.7	10.07	*	*
12"	10	323.9	4.57	381	152.4	12.7	8.15	x	x
12"	40	323.9	9.53	381	152.4	12.7	14.29	*	*
14"	10S	355.6	4.78	412.8	152.4	12.7	10.89	*	*
16"	10S	406.4	4.78	469.9	152.4	12.7	12.7	*	*
18"	10S	457.2	4.78	533.4	152.4	12.7	17.24	*	*
20"	10S	508	5.54	584.2	152.4	12.7	21.77	*	*
24"	10S	609.6	6.35	692.2	152.4	12.7	27.22	*	*