

GN 99.6

Clamping levers

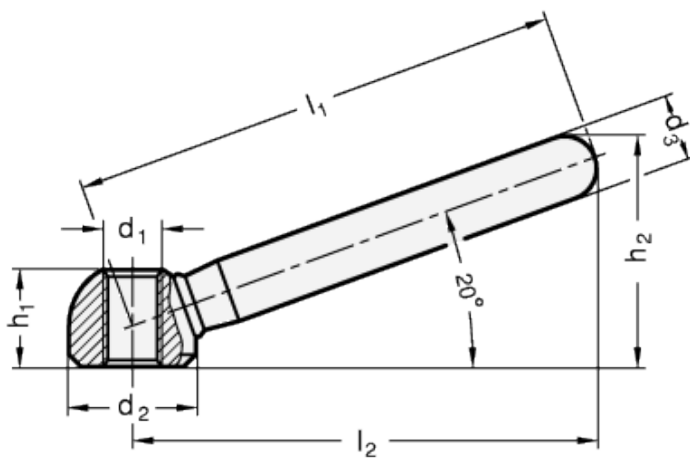

INOX
Stainless Steel



technical informations

Material

AISI 304 stainless steel, sandblasted matte finish. The lever arm is butt-welded to the hub.

Assembly

Tapped through hole.

Features and applications

AISI 304 stainless steel, thanks to its high resistance to corrosion allows the application of these clamping levers on machines and equipment in those sectors where laws or particular hygienic, climatic and environmental factors make it mandatory to use corrosion resistant materials.

Standard Elements	Main dimensions					Mounting hole		Weight
Description	l_1	d_2	d_3	$h_2 \approx$	$l_2 \approx$	d_1	h_1	g
GN 99.6-63-M8	63	16	10	30.5	60	M8	12.5	39

GN 99.6-80-M10	80	20	12	37	76	M10	15	75
GN 99.6-100-M12	100	25	14	46	95	M12	19	147
GN 99.6-125-M16	125	32	18	58.5	119	M16	25	309
GN 99.6-160-M20	160	40	20	73	152	M20	31	526



ELESA and GANTER models all rights reserved in accordance with the law. Always mention the source when reproducing our drawings.

STANDARD MACHINE ELEMENTS WORLDWIDE